

Pro-Kits Ltd Additional Products

Pedestals

Extension stems

Chain Wheels

Interlocks

Positioners

Worm Gears

Spool type kits

Painting, powder coating & Galvanising

Rotary to linear conversions

Lock out / locking devices

Mounting kits

Solenoid valves

Switchboxes

Linkages

Spring return levers

Reducing inserts

Contact us at

Pro-Kits Ltd

Professional Solutions for the Valve Industry
Tel: +44 (0)1773 860629 • Fax: +44 (0)1773 860672

The UK's largest independent mounting kit manufacturer, we supply everything for the valve industry except valves and actuators.



Pro-Switch



Limit Switch Boxes

The Better Alternative

PK-100 Switchbox

Features:

- Visual position indicator
- Quickset Cams - adjustable without tools
- 8 Way terminal strip
- 1x M20 conduit entries
- Captive cover bolts
- Mounting bracket to suit any VDI / VDE actuator.

PLEASE SPECIFY PINION HEIGHT WHEN ORDERING



PK-120 Switchbox

Features:

- Visual position indicator
- Quickset Cams - adjustable without tools
- 6 Way terminal strip
- 1x M20 conduit entries
- Captive cover bolts
- Legs to mount to any VDI / VDE actuator

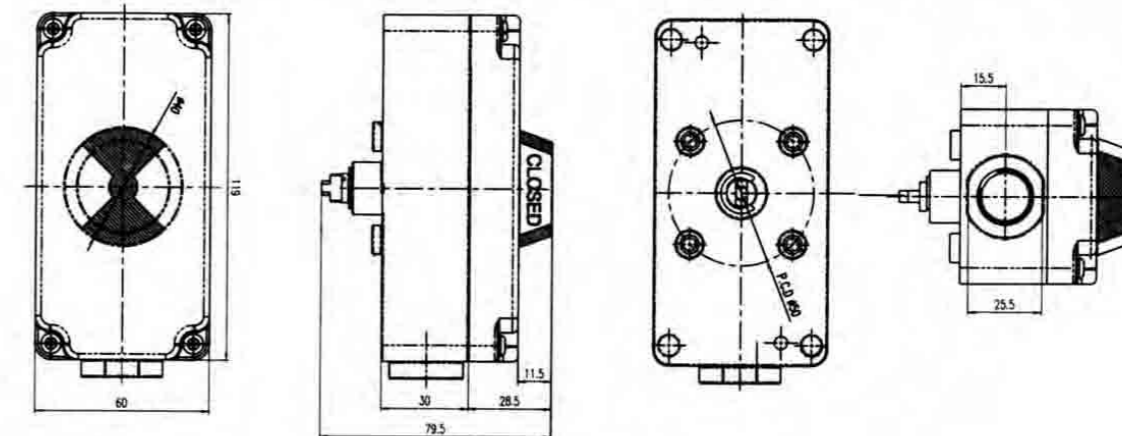
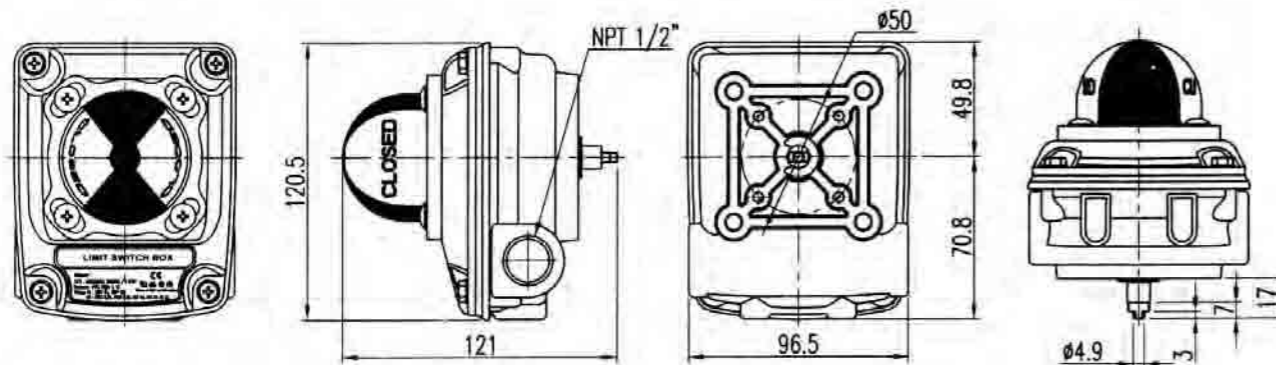
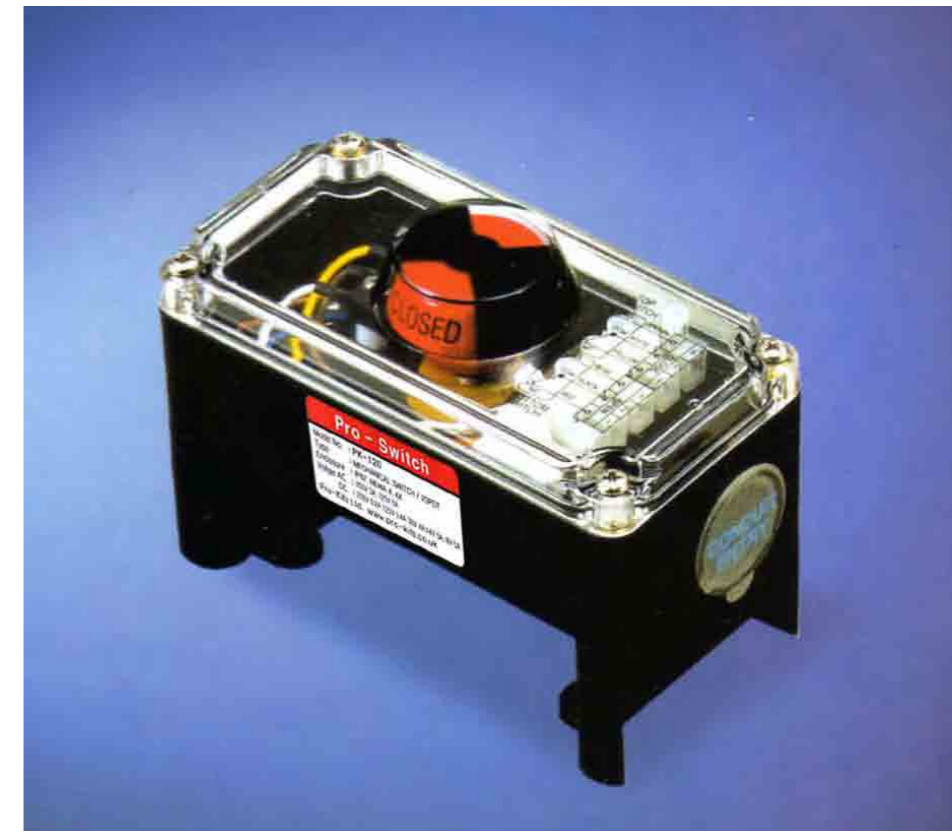

Specification	Standard
Enclosure Protection	Weather proof, IP67/NEMA4 & 4X
Ambient Temp.	-20°~80°C
Conduit Entry	2x M20
Switches	2x Mechanical Switches
Terminal	8 Points
Shaft	Standard Shaft (17mm)
External Coating	Polyester powder coating (Black)
Weight	880g

Material	
Housing	Aluminium Die-casting
Shaft	Stainless Steel
Indicator Cover	Polycarbonate
Indicator	ABS/Polycarbonate
Cam	Polycarbonate
Spring	Stainless Steel
O-Ring	NBR
Bracket	Stainless Steel

Specification	
Enclosure Protection	IP67
Ambient Temp.	-20°~80°C
Conduit Entry	M20*1.5P
Switches	2x Mechanical Switches (2SPDT)
Rating	AC 250V 3A, 125V 5A
Voltage	DC 250V 0.2A, 125V 0.4A, 30V 4A
Terminal	6 Points
Weight	220g

Also in our range are switchboxes for intrinsically safe, explosion proof, field bus, profibus and ASI systems. Pneumatic switch option also available.